



**RUST  
BUSTER**  
FRAMEWORKS

**RB7320**

**99-06 Chevy/GMC  
Rear Shock Crossmember**



**VIDEO AVAILABLE**

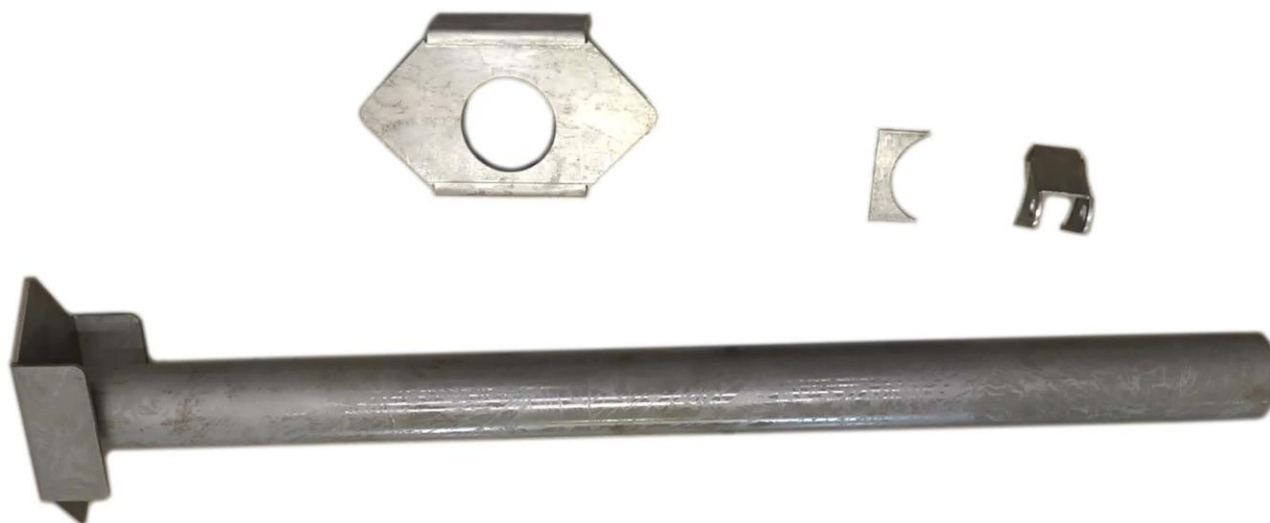

**REQUIRED TOOLS**

Jack Stands or Lift  
Mig Welder  
Paint/Primer  
Locking Pliers  
Hand Grinder  
Cutting Wheel or Torch  
Welding Gloves  
Welding Hood/Shield  
Ear & Eye Protection  
Sockets & Ratchet  
Fire Extinguisher & Water

**KIT CONTAINS**

Tube Crossmember  
Frame Mounting Plates  
Shock Mount  
Passenger Side Frame Gusset

**QTY**

1  
2  
1  
1



**RUST  
BUSTER**  
F R A M E W O R K S

**RB7320**

**99-06 Chevy/GMC  
Rear Shock Crossmember**

**1) PREPARING YOUR VEHICLE**

Begin by disconnecting your battery prior to starting your installation.

Inspect your vehicle for leaking fuel lines, fuel tank and engine components. If you have fuel leaks repair all leaks prior to starting your installation. If your fuel tank is near your welding area **remove your tank prior to welding.**

Remove all combustible items above the work area such as seats, carpets, padding, etc.

**Keep all flammable materials away from the vehicle work area.**

**2) PREPARING YOUR WORKSTATION**

Keep a fire extinguisher and water close by in the case of fire and make sure you always have a designated "Fire Watch" to assist during the cutting or welding phases.

Abide by all apprenticed welding safety standards and practices.

Always use appropriate welding eye protection, ear protection, and work and fire safety gloves during the installation and within the work area.



**WARNING!**

If you are unsure on how to perform the installation or how to operate any of the required tools listed above, it is **HIGHLY** advised that you enlist the work of a certified welder/installer.

Failure to follow proper safety precautions and instructions may result in serious injury. **The user assumes all liability when installing the product.**



# RUST BUSTER

F R A M E W O R K S

RB7320

## 99-06 Chevy/GMC Rear Shock Crossmember

### 3) PREPARING FOR YOUR INSTALL

Remove your vehicle's bed. We show how to do this in a video over on our YouTube channel, [www.YouTube.com/RustBusterFrameworks](http://www.YouTube.com/RustBusterFrameworks)



With a clip remover tool, remove any wiring harness and fire hazard from the crossmember.



Disconnect your shock with a 17mm socket.



### 4) CUT & CLEAN

Take note of the location and rotation of your shock mount.

Cut away the crossmember and any rust and debris to help prevent it transferring to the tube.



Clean the frame free of rust and debris, revealing bare metal.

(OPTIONAL) Paint the part and work area with a weldable primer to help prevent against rust.





# RUST BUSTER

F R A M E W O R K S

RB7320

## 99-06 Chevy/GMC Rear Shock Crossmember

### 5) WELD

Insert the tube into the frame and cap it with the included mounting plates.

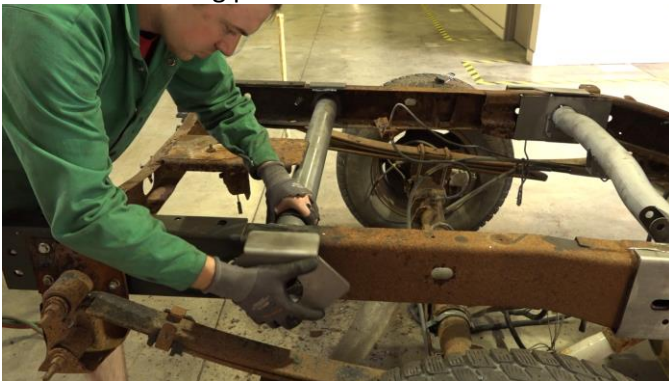

Weld the spare tire support to the crossmember.

Reassemble your wiring.

Reassemble your shock.

Remove any potential fire hazards from the work area. Tac-weld the parts to the frame using their shapes for alignment. Following proper welding procedures, begin welding the part.

100% weld around all edges.

Using your shock and factory crossmember shock as a reference, weld your new shock mount to the crossmember. The included gusset will be installed on the passenger side, inside the C-channel, up against the pipe.

